

- Ultrafix hex-head screw
21v Ø 3/8" x 5.85 in.
- Extralarge anchor
Ø 0.70 in. x 5.26 in.

A leader doesn't follow steps, **he marks the way.**

WHAT'S A DELINEATOR POST?

This reboundable plastic delineator post aligns, delimits, or directs reserved areas for pedestrians or motorists.

WHAT DOES A BRIO DELINEATOR POST DO?

The main function of this delineator post is to avoid vehicles invading forbidden zones and work as a traffic safety channeler in bike lanes, parking lot accesses, or even pedestrian crossings.

USES

Mainly suggested in rows preventing vehicles from parking on the sidewalks or invading danger zones.

Features

- Vehicle impact resistant.
- It returns to its original position after an impact. It bears more than 5,000 collisions.
- Made of highly resistant plastic that doesn't damage vehicles.
- It bears accidental collisions lower than 5.5 US ton.
- Line color: Yellow, white, green, or blue of great visibility.
- It includes two Engineer Grade Prismatic reflective stripes that improve its visibility at night.
- Easy to install and replace.
- To achieve secure floor anchoring, you will need four screws, four 3/8" flat washers, and four Extralarge anchors (not included).
- **IT HAS THE OPTION OF ADDING A LIGHTING SYSTEM**
- Smart Solar Lighting System.
- 5 ultra-bright LEDs.
- 40000 mcd with a low current of 18000 mA and 40000 mW.
- Colors: Amber, red, green, blue, and white.

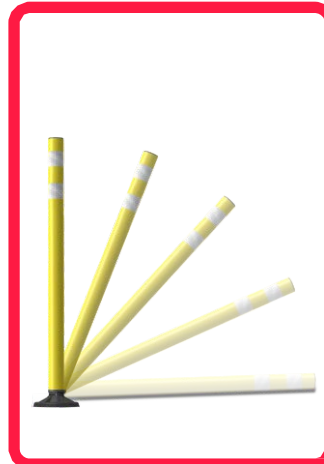

Volumes, dimensions, and other measures are nominal and may vary by approximately 2 %.

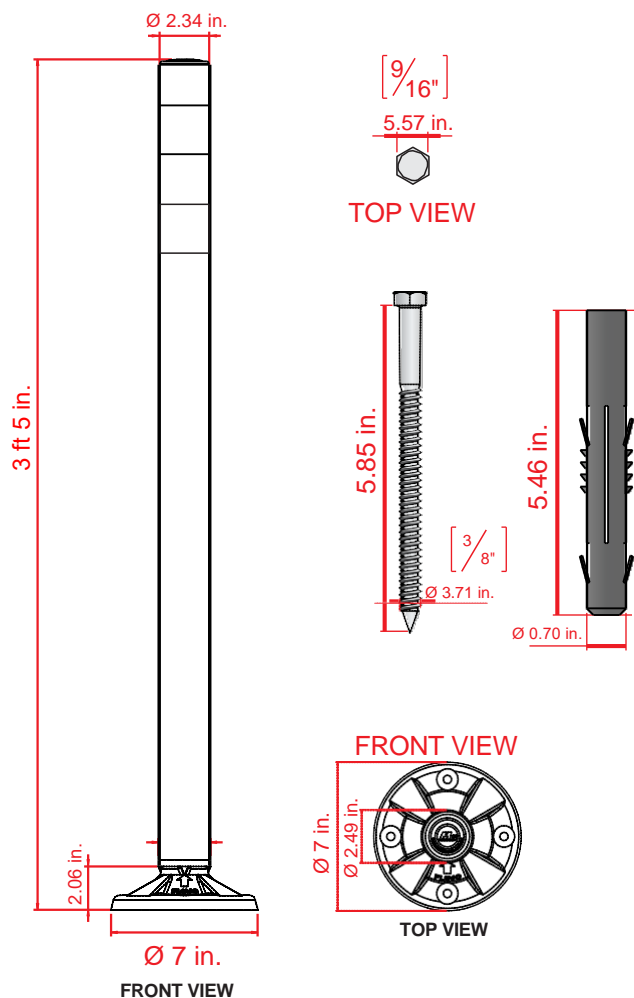

Measures

| | |
|--------------------------|--|
| Total | Height: 3 ft 5 in. Base Ø 7 in. Top Ø 2.34 in. |
| Reflective: | 2.34 in. x 7 in. stripe. |
| Reflective color: | White or amber. |
| Weight: | 2.28 lb. |

Installation

Use the base of the delineator post as a template. Mark the four boreholes with a drill and a 3/4" concrete drill bit. Bore into the holes to a depth of 7". Place the anchors on the boreholes. Put the delineator post. Insert the screws and the 3/8" flat washers. Perfectly tighten the four screws with a 9/16" socket wrench. The installation is ready.

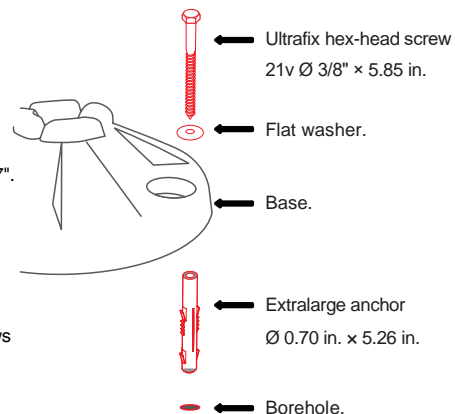

+ safety
+ resistance
- price