

Images are merely illustrative models.

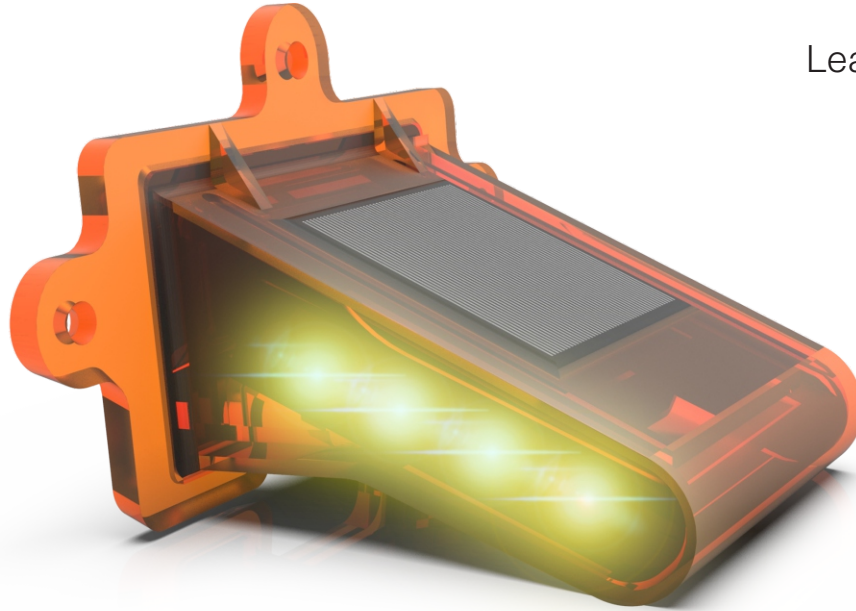

Leader don't follow steps  
... marks the way

## FEATURES

- Rounded body with no sharpen edges.
- Very important warning night element.
- Autorechargeable, with auto turn on/off sensitive to light conditions, turn off in day and on, during nights.
- Easy handle and installation.
- Efficient design applying solar technology and 4 ultrabright leds.
- Great visibility on any weather condition.
- Has a solar panel area to get enough illumination for a "long distance visibility".

## Luminous System

- |   |  |
|---|--|
| • <b>Manufactured out in:</b>               | Polycarbonate UV protected.                        |
| • <b>Body color:</b>                        | Amber.   |
| • <b>Measure:</b>                           | Length: 5.51 in., width: 3.34 in., height: 3.5 in. |
| • <b>Water absorption:</b>                  | waterproof.  |
| • <b>Solar panel:</b>                       | Silicon.   |
| • <b>solar panel measure:</b>               | L: 0.21 in., w: 0.21 55 in..                       |
| • <b>Color led:</b>                         | Red or amber/ High intensity.                      |
| • <b>Leds:</b>                              | 4.   |
| • <b>Led intensity:</b>                     | + 10,000 Microcandels.                             |
| • <b>2 long life rechargeable batteries</b> | NK-MTH.  |
| • <b>Flasher light sequence:</b>            | 70 flashes per minute.                             |
| • <b>Led visibility from distance:</b>      | 211 yds.   |
| • <b>Circuit efficiency:</b>                | (48 hrs) operation by charge (5 hrs).              |

## WHAT IS THE BARRIER SOLAR LAMP ?

The Barrier Solar Lamp is a device manufactured in high resistance polycarbonate plastic amber color.

With an auto-rechargeable system by a solar cell with a photosensor to auto turn on/off.

Illumination by high intensity leds amber or red in flashing mode.

To install or central or lateral barriers in highways or in tunnels walls.

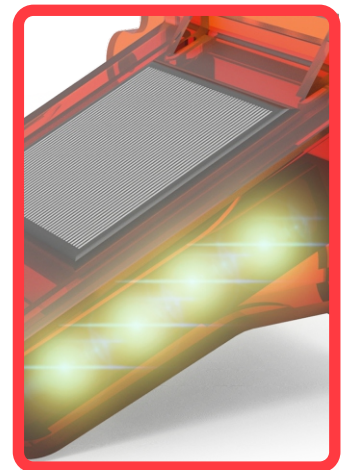



Installation elements:

1. Barrier Solar Lamp
- 2.- Central barrier or tunnel to place it.
- 3.- Epoxic glue.
- 4.- Shoots (optional) or rivets.

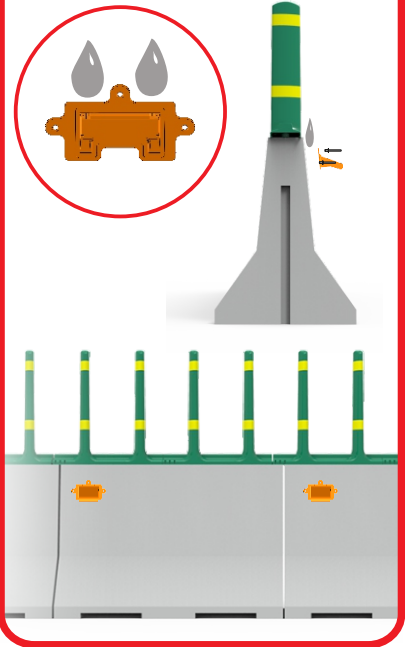
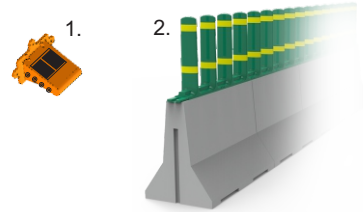

**Anchorage procedure:**

- 1.- Clean the barrier to get free of dust or oily substances.
- 2.- Clean the device for a better performance too.
- 3.- Prepare the epoxic glue making the mix. Each Barrier Lamp uses 2,82 oz.
- 4.- Optional installation by shoot powder tool or riveter. Each device requires 3 shoots.

Measures are nominal and can vary between +/- 2%.

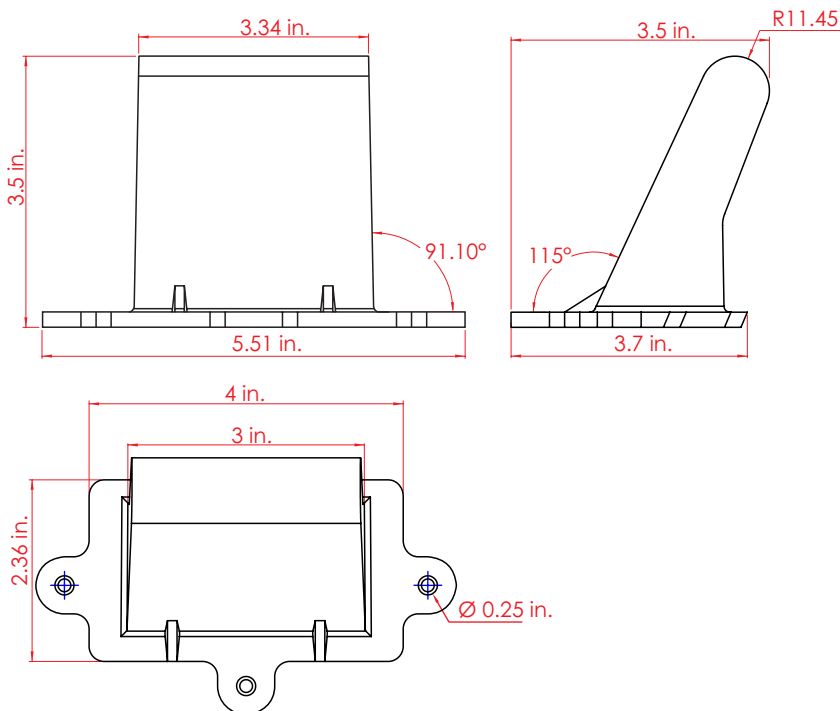

**Measure:**

Length: 5.15

**Reflective:**

Width: 3.34 in.  
Height: 3.5 in.  
4 lateral leds

**Led Color:**

Red or amber