



Leader don't follow steps
... marks the way



WHAT IS THE MULTIVISTA BUTTON?

- Buttons or Cat Eyes are retro-reflectives markers for traffic on different conditions: parking lots, low visibility zones or for a guide to users.
- We put them on floor to channelize vehicle traffic, made indications, or as a speed reducers, rumblers and for distribute lanes. Is a so necessary, practic and discret item. Buttons doesn't cause distractions to drivers and don't take out their sight apart from the way, but they made an attention call with its reflectives.
- In this case the reflective material are spheres that brights in darkness, so the device has better visibility during night hours, when accidents can be worse.
- Buttons represent 6 times savings in cost of thermoplastic painting each year.
- Buttons also means 50% of savings in time and material.
- This is part of the for-bicycle-tracks engineered equipment we produce proudly and also give good service in parking lots, pedestrian zones and else.

Features

- Manufactured in ABS yellow plastic, we also has in white, red, blue or green all of them with UV protection too.
- The button has 5 acrylic metallized retro-reflective spheres (you can choose one or two faces) and are the best for confine, delimit and mark one way or two way lanes on any road.
- Its material are resistant to any run-in, from bicycles to trailers, from cars to buses without ripping or losing its shape.
- ABS thickness and its advanced technology are considered as a long duration road equipment. But it also has the option to be fixed with a strong bolt for concrete.
- The bolt does not ripp or decay and can't harm vehicle's wheels.
- Road Abs buttons are easy to install and need no maintenance.
- Its strong properties: resistant to friction, attrition, humidity or rain made the perfect option for your bicycle lanes.
- Commonly buttons are installed with a two-components-epoxic glue, this substance has demonstrated to be high temperature resistant and also immune to chemical and physical agents.



Measures are nominal
and can vary,
between $\pm 2\%$

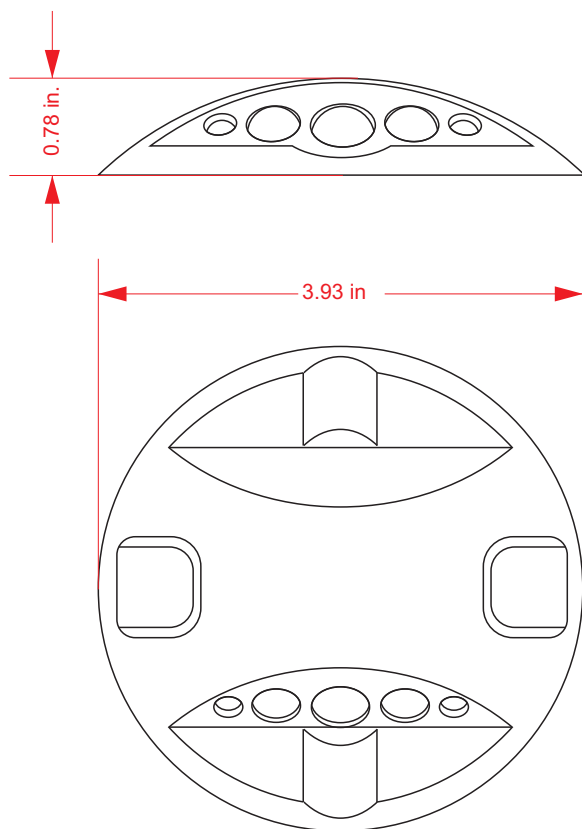

Measure

Total	Diameter: 3.93 in. Height: 0.78 in
Reflective:	Acrylic Spheres
Reflective:	Amber, white, red, blue or green

installing directions

Installing must be done hand made with recommended epoxic glue

- 1- Prepare the surface. Must be clean and dry. Mark the site of installation in a triangular pitch scheme of 10 inches.
- 2- Put epoxic glue in all the surface of the reverse button (3.5 oz aprox.).
- 3- Place the button and press it. This is an important step for strong fixation.
- 4- The other installation way is fixing with glue and a bolt. In this case perforate floor with a 1/2" bit drill to a 3" depth. Go to step 2.
- 5- Dry time for glue fixation in almost two hours.

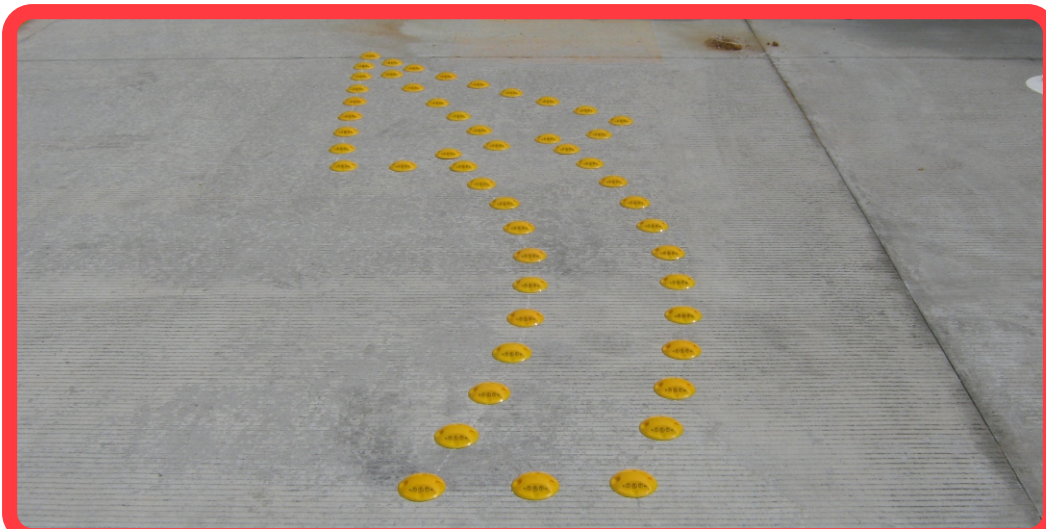
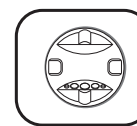
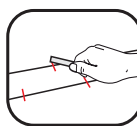

NOTE: DIRECTIONS FOR PREPARING TWO COMPONENTS EPOXIC GLUE

TAKE SIMILAR QUANTITIES OF
BOTH COMPONENTS
"A" + "B".

MAKE A HOMOGENEOUS MIX.

ATTENTION:

LEFTOVERS OF EPOXIC GLUE
MOST BE DISPOSABLE
ONE TIME USE